



Address
390 West Bay Road, KY1-1203 George Town,
Grand Cayman, Cayman Islands,

Contact
+1 345 949 3521
info@diamondproperties.ky

MODERN WAREHOUSE (PRE-CONSTRUCTION)

School Road, George Town, Cayman Islands

PROPERTY DETAILS

Price: CI\$2,600,000	MLS#: 413559	Type: Commercial
Listing Type: Warehouse	Status: Current	Bedrooms: -
Bathrooms: -	Built: 2022	Acreage: 0.2922
Sq. Ft.: 3613		

PROPERTY DESCRIPTION

Pre-Construction 3 Unit warehouse development, located on the north end of School Road in the heart of George Town. The warehouse will contain three units, ranging from 928 square feet up to 1365 square feet. The warehouse will be built to the similar standards as Dade County Florida with a 150 mph hurricane rated structure, at an elevation above Ivan flood level (approx 9 ft above MSL). Each unit will have its own front roller door and single entry door. The property features security cameras, perimeter fencing, and built using fortified concrete. The units are of modern design with market leading insulation in the roof (R-30) and walls (R-22). The floor to ceiling height is 21 feet. Construction due to begin in January 2022.

PROPERTY FEATURES

Views	Inland
Block	14BG
Parcel	52
Foundation	Slab
Zoning	Commercial Neighbourhood
Lease Details	3,613 square feet
Furnished	No
Road Frontage	66 ft

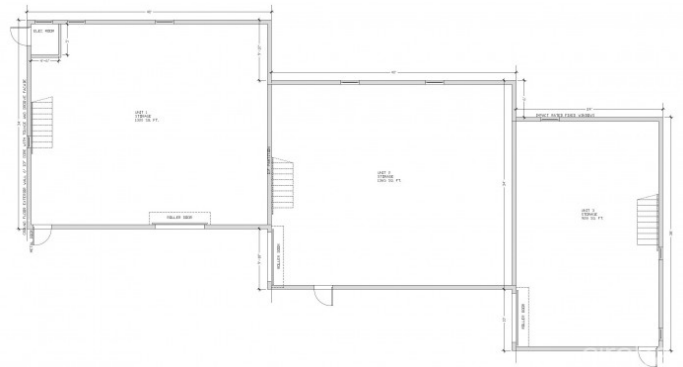
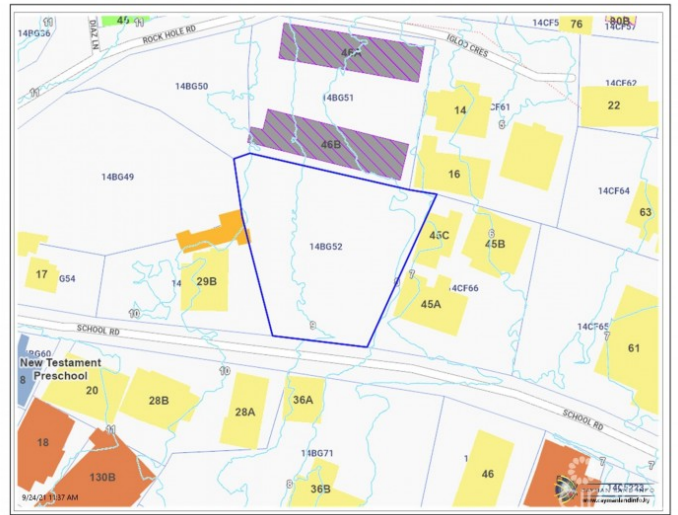

CIREBA MLS LDX feed courtesy of INTERNATIONAL REALTY GROUP

***Disclaimer:** The information contained herein has been furnished by the owner(s) and or their nominee and represented by them to be accurate. The listing company, agent and CIREBA MLS disclaims any liability or responsibility for any inaccuracies, errors or omissions in the represented information. The listing details herein are also courtesy of CIREBA (Cayman Islands Real Estate Brokers Association) MLS and/or via LDX (Listing Data Exchange) feed. All the information contained herein is subject to errors, omissions, price changes, prior sale or withdrawal, without notice and is at all times subject to verification by the purchaser(s).